

THE FIFE COUNCIL (BENARTY AREA - LOCHORE, CROSSHILL AND GLENCRAIG - SPEED LIMITS) ORDER 2026

On 11/03/2026 Fife Council made an Order under the Road Traffic Regulation Act 1984, the effect of which is as stated in the issue of the Dunfermline Press published on 09/10/2025.

A copy of the Order, which is operational from 01/04/2026 and a drawing showing the affected roads, may be inspected, without payment of fee, during normal office hours at Fife Council Headquarters, Fife House, North Street, Glenrothes and via public access pc's at your closest library. The documents will also be available online at www.fife.gov.uk/notices.

Any queries regarding this Order should be directed to Traffic Management, Roads & Transportation Service, Bankhead Central, Bankhead Park, Glenrothes, Fife KY7 6GH or by e-mail to traffic.management@fife.gov.uk.

19/03/26

Picture caption: Images of signed Traffic Regulation Order.

**THE FIFE COUNCIL (BENARTY AREA - LOCHORE, CROSSHILL AND GLENCRAIG -
SPEED LIMITS) ORDER 2026**

The Fife Council in exercise of the powers conferred on them under section 84(1) of the Road Traffic Regulation Act 1984 and of all other enabling powers, and after consultation with the chief officer of police for the Council's area in accordance with section 124 of and Part III of Schedule 9 to the said Act hereby make the following Order:-

1. This Order may be cited as "The Fife Council (Benarty Area - Lochore, Crosshill and Glenraig - Speed Limits) Order 2026" and shall come into operation on the First day of April Two Thousand and Twenty Six.
2. No person shall drive any motor vehicle at a speed exceeding 20 miles per hour on the lengths of road specified in Schedule 1 to this Order.
3. No person shall drive any motor vehicle at a speed exceeding 30 miles per hour on the lengths of road specified in Schedule 2 to this Order.
3. Nothing in this Order shall apply to any vehicle which falls within regulation 3(4) of the Road Traffic Exemptions (Special Forces) (Variation and Amendment) Regulations 2011 when used in accordance with regulation 3(5) of those Regulations.
4. The Fife Council (Benarty Primary School, Ballingry – Part Time 20 M.P.H. Speed Limit) Order 2007 is hereby revoked.
5. The Fife Council (B920 Glenraig to Lochgelly – 30 M.P.H. Speed Limit) Order 2016 is hereby revoked.
6. The Fife Regional Council (Speed Limits) (Consolidation) (Revocation) Order 1992 shall be amended as follows:

In Schedule 1 (30 m.p.h Restricted Roads) Dunfermline District delete the following entry

"Ballingry/Glenraig" from Town/Village and "TM/SLO/D/5" from Drawing No.
7. Drawing numbers TRO25_60/PN, TRO25_60/PS, TRO25_60/30N and TRO25_60/30S showing the roads affected by this Order delineated in black are annexed and signed as relative hereto.

Dated this Eleventh day of March Two Thousand and Twenty Six.

..... Proper Officer of the Council

SCHEDULE 1/

SCHEDULE 1
20MPH SPEED LIMIT

**B920 Main Road/Main Street/Lochleven
Road, Lochore**

From a point 110 metres or thereby south
of the extended south kerblīne of Manse
Road to a point 20 metres or thereby
north of the extended north kerblīne of
New Flockhouse, a distance of 1765
metres or thereby.

**Balbedie Court, Lochore
Mucklestane Court, Crosshill**

For their entire lengths.



..... Proper Officer of the Council

SCHEDULE 2
30MPH SPEED LIMIT

B920 Glenraig to Lochgelly

From a point 110 metres or thereby south
of the extended south kerblīne of Manse
Road in a southerly direction for a
distance of 1130 metres or thereby.

B920 Lochleven Road, Ballingry

From a point 20 metres or thereby north
of the extended north kerblīne of New
Flockhouse to a point 231 metres or
thereby northeast of the extended north
kerblīne of Hill Road, a distance of 756
metres or thereby



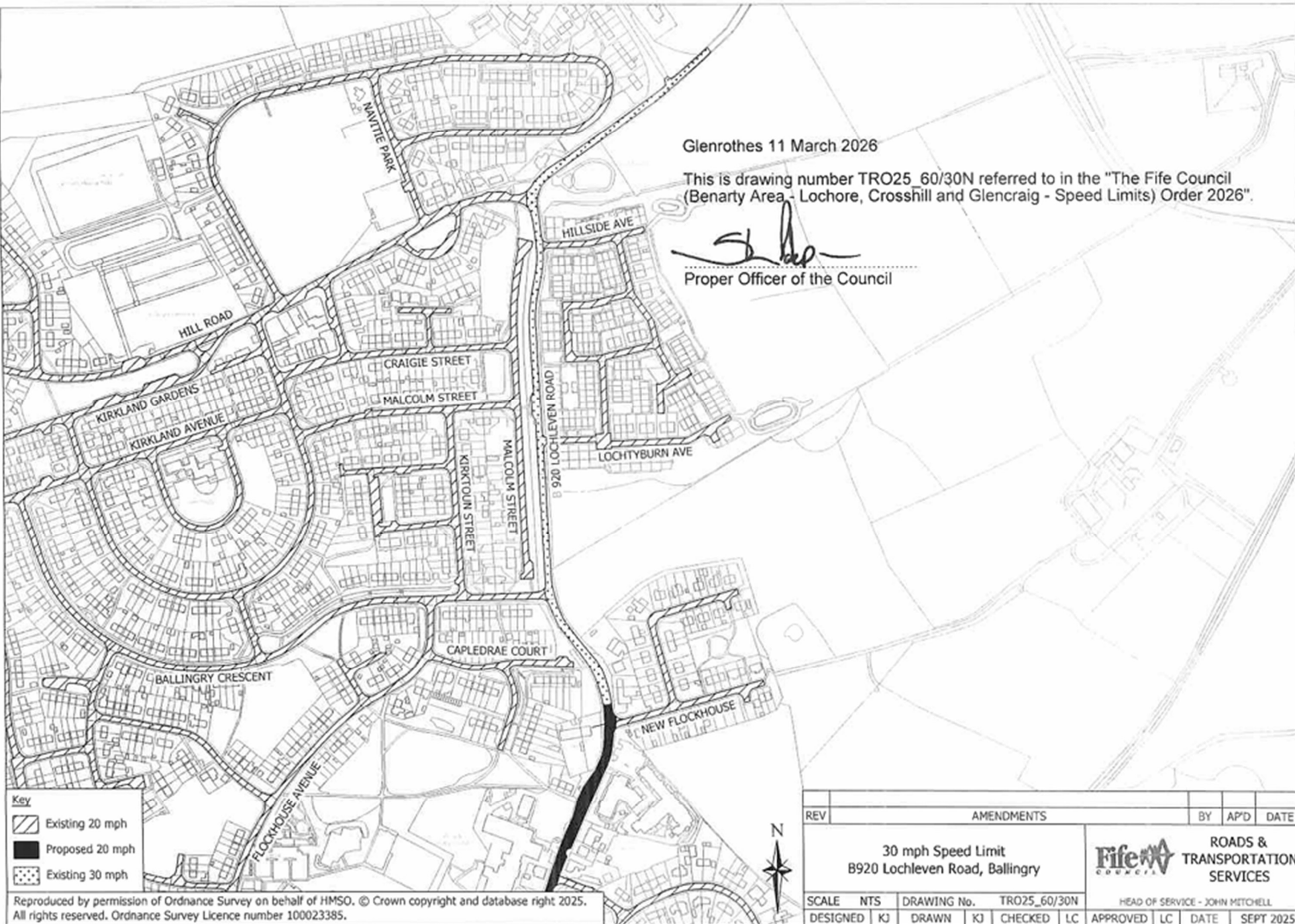

..... Proper Officer of the Council



Glenrothes 11 March 2026

This is drawing number TRO25_60/30N referred to in the "The Fife Council (Benarty Area - Lochore, Crosshill and Glenraig - Speed Limits) Order 2026".

[Signature]
 Proper Officer of the Council

- Key**
-  Existing 20 mph
 -  Proposed 20 mph
 -  Existing 30 mph

Reproduced by permission of Ordnance Survey on behalf of HMSO. © Crown copyright and database right 2025. All rights reserved. Ordnance Survey Licence number 100023385.



REV	AMENDMENTS	BY	AP'D	DATE
	30 mph Speed Limit B920 Lochleven Road, Ballingry			
SCALE	NTS	DRAWING No.	TRO25_60/30N	
DESIGNED	KJ	DRAWN	KJ	CHECKED LC
APPROVED LC		DATE		SEPT 2025

Fife COUNCIL
 ROADS & TRANSPORTATION SERVICES

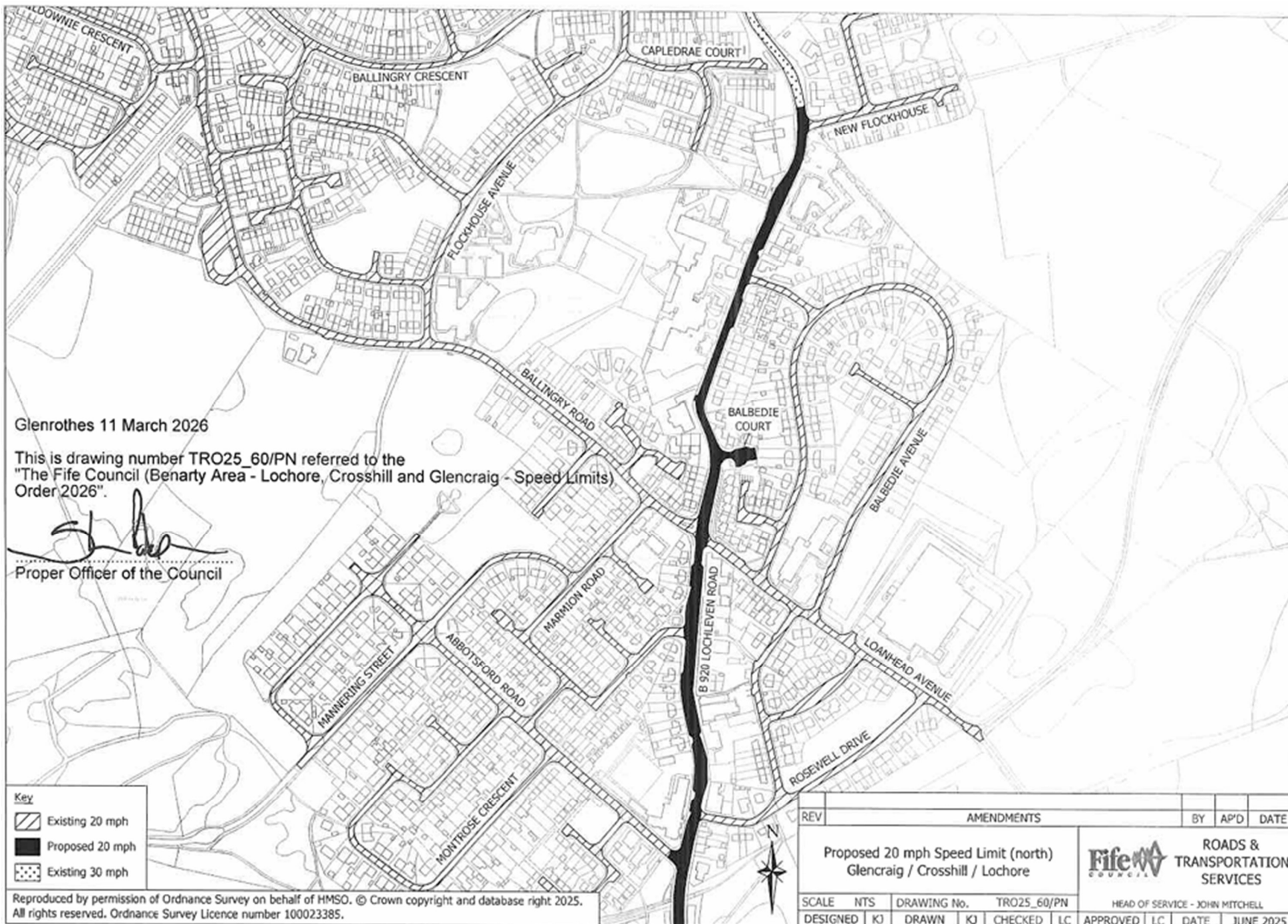

HEAD OF SERVICE - JOHN MITCHELL



Glenrothes 11 March 2026

This is drawing number TRO25_60/PN referred to the "The Fife Council (Benarty Area - Lochore, Crosshill and Glenraig - Speed Limits) Order 2026".

[Signature]
Proper Officer of the Council

Key	
	Existing 20 mph
	Proposed 20 mph
	Existing 30 mph

Reproduced by permission of Ordnance Survey on behalf of HMSO. © Crown copyright and database right 2025. All rights reserved. Ordnance Survey Licence number 100023385.

REV	AMENDMENTS	BY	AP'D	DATE
	Proposed 20 mph Speed Limit (north) Glenraig / Crosshill / Lochore			
SCALE	NTS	DRAWING No.	TRO25_60/PN	
DESIGNED	KJ	DRAWN	KJ	CHECKED LC
APPROVED LC		DATE	JUNE 2025	

Fife COUNCIL
ROADS & TRANSPORTATION SERVICES

HEAD OF SERVICE - JOHN MITCHELL



Glenrothes 11 March 2026

This is drawing number TRO25_60/PS referred to in the "The Fife Council (Benarty Area - Lochore, Crosshill and Glenraig - Speed Limits) Order 2026".

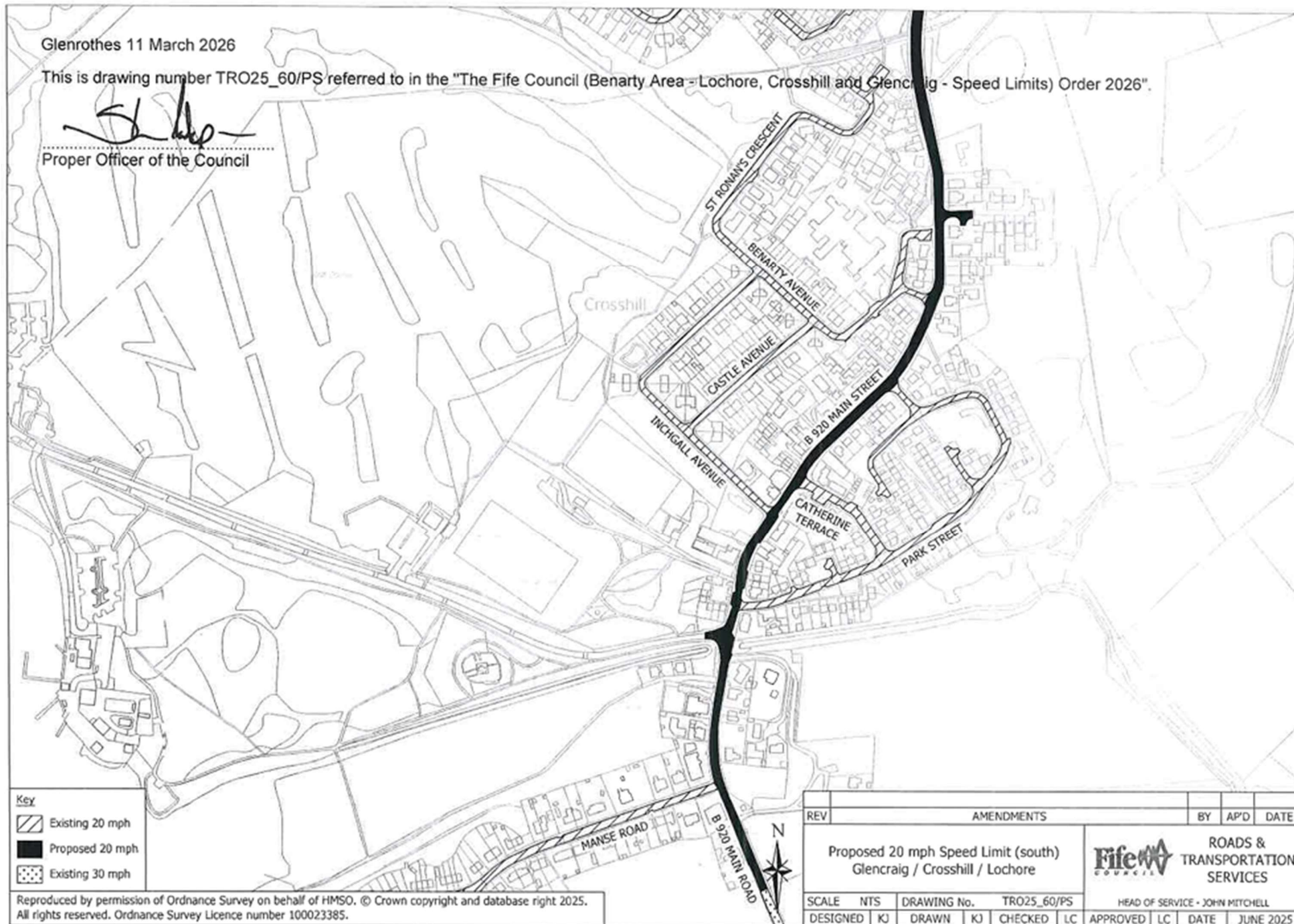
Proper Officer of the Council



Key

	Existing 20 mph
	Proposed 20 mph
	Existing 30 mph

Reproduced by permission of Ordnance Survey on behalf of HMSO. © Crown copyright and database right 2025. All rights reserved. Ordnance Survey Licence number 100023385.

REV	AMENDMENTS	BY	AP'D	DATE					
	Proposed 20 mph Speed Limit (south) Glenraig / Crosshill / Lochore								
SCALE	NTS	DRAWING No.	TRO25_60/PS	HEAD OF SERVICE - JOHN MITCHELL					
DESIGNED	KJ	DRAWN	KJ	CHECKED	LC	APPROVED	LC	DATE	JUNE 2025



Glenrothes 11 March 2026



This is drawing number TRO25_60/30S referred to in the "The Fife Council (Benarty Area - Lochore, Crosshill and Glenraig - Speed Limits) Order 2026"

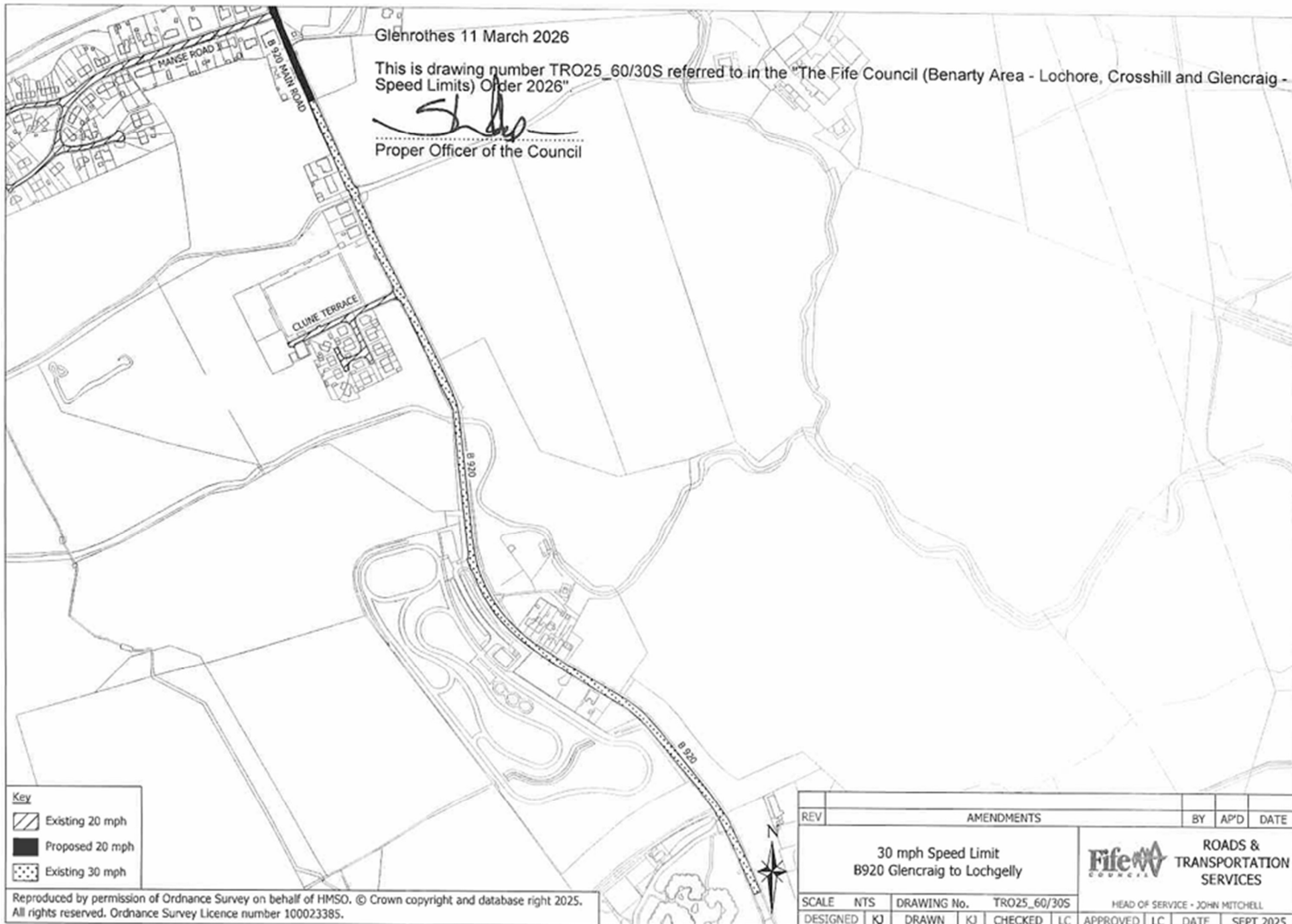

Proper Officer of the Council



Key

-  Existing 20 mph
-  Proposed 20 mph
-  Existing 30 mph

Reproduced by permission of Ordnance Survey on behalf of HMSO. © Crown copyright and database right 2025. All rights reserved. Ordnance Survey Licence number 100023385.

REV	AMENDMENTS	BY	AP'D	DATE					
	30 mph Speed Limit B920 Glenraig to Lochgelly								
SCALE	NTS	DRAWING No.	TRO25_60/30S	HEAD OF SERVICE - JOHN MITCHELL					
DESIGNED	KJ	DRAWN	KJ	CHECKED	LC	APPROVED	LC	DATE	SEPT 2025