

THE FIFE COUNCIL (BURNTISLAND) (SPEED LIMITS) ORDER 2025

Fife Council propose to make an Order under the Road Traffic Regulation Act 1984 to introduce speed limits in various streets in Burntisland as follows: **20mph speed limit – A921 Aberdour Rd** from Collinswell Dr to A909 Cowdenbeath Rd; **A909 Cowdenbeath Rd** – from A921 Aberdour Rd to a point 16m or thereby west of the extended northwest kerblin of Craig Ct for approx. 533m; **B923 Kirkcaldy Rd** – from A909 Cowdenbeath Rd to a point 156m northeast of the extended northeast kerblin of Greenmount Rd North for approx. 542m; **A921 Cromwell Rd** - for its entire length; **A921 Kinghorn Rd** – from High St to the extended west boundary line of Burntisland Cemetery for approx. 1145m; **Lochies Rd** – for its entire length; and **Grange House Gdns** – for its entire length. **30mph speed limit – A921 Kinghorn Rd** from the extended west boundary line of Burntisland Cemetery to a point 31m or thereby east of the extended east kerblin of Linwell Court for approx. 277m; **A921 Aberdour Rd** from Collinswell Dr to a point 28m or thereby west of the extended west kerblin of Bendameer Rd for approx. 506m. **40mph speed limit – A909 Cowdenbeath Rd** from a point 16m or thereby west of the extended northwest kerblin of Craig Ct in a westerly direction for approx. 643m.

Full details of the proposals may be examined during opening hours at Fife Council Headquarters, Fife House, North Street, Glenrothes and via public access pc's at your closest library. The documents will also be available online at www.fife.gov.uk/notices

Objections to the proposals, stating the grounds of objection and the objector's name & address, should be sent to Traffic Management, Roads & Transportation Service, Bankhead Central, Bankhead Park, Glenrothes, Fife KY7 6GH or by e-mail to traffic.management@fife.gov.uk by 12/06/25.

15/05/25

THE FIFE COUNCIL (BURNTISLAND) (SPEED LIMITS) ORDER 2025

STATEMENT OF REASONS

The Fife Council, after consultation with the chief officer of police for the Council's area, consider that it is necessary to introduce speed limits at various streets in Burntisland in the interest of road safety.

Lindsay Thomson,
Head of Legal and Democratic Services.

Fife House,
North Street,
GLENROTHES,
Fife.
KY7 5LT

THE FIFE COUNCIL (BURNTISLAND) (SPEED LIMITS) ORDER 2025

The Fife Council (“the Council”) in exercise of the powers conferred on them by sections 84(1) and 124(1) of and Part IV of Schedule 9 to the Road Traffic Regulation Act 1984 and of all other enabling powers, and after consultation with the chief officer of police for the Council’s area in accordance with Part III of Schedule 9 to the said Act hereby make the following Order:-

- 1. This Order may be cited as "The Fife Council (Burntisland) (Speed Limits) Order 2025" and shall come into operation on the day of Two Thousand and Twenty Five.**
- 2. The Interpretation Act 1978 shall apply for the interpretation of this Order as it applies for the interpretation of an Act of Parliament.**
- 3. No person shall drive any motor vehicle at a speed exceeding 20 miles per hour on the lengths of road specified in Schedule 1 to this Order.**
- 4. No person shall drive any motor vehicle at a speed exceeding 30 miles per hour on the lengths of road specified in Schedule 2 to this Order.**
- 5. No person shall drive any motor vehicle at a speed exceeding 40 miles per hour on the length of road specified in Schedule 3 to this Order.**
- 6. The Fife Regional Council (Speed Limits) (Consolidation) (Revocation) Order 1992 shall be amended as follows:-**

In Schedule 1 (30 m.p.h. Restricted Roads) Kirkcaldy District delete "Burntisland" from Town/Village and delete "TM/SLO/K/6" from Drawing No.
- 7. The Fife Council (Burntisland Primary School – Part Time 20 mph Speed Limit) Order 2004 shall be revoked entirely.**
- 8. The Fife Council (A909 Cowdenbeath Road, Burntisland – 30 mph Speed Limit) Order 2020 shall be revoked entirely.**
- 9. Nothing in this Order shall apply to any vehicle which fall within regulation 3(4) of the Road Traffic Exemptions (Special Forces) (Variation and Amendment) Regulations 2011 when used in accordance with regulation 3(5) of those Regulations.**
- 10. Drawing numbers TRO25_05/PW and TRO25_05/PE showing the roads affected by this Order delineated in black are annexed and signed as relative hereto.**

Dated this day of Two Thousand and Twenty Five.

..... **Proper Officer of the Council**

SCHEDULE 1
20mph Speed Limit

A921 Aberdour Road, Burntisland

**From Collinswell Drive to A909
Cowdenbeath Road.**

A909 Cowdenbeath Road, Burntisland	From A921 Aberdour Road to a point 16 metres or thereby west of the extended northwest kerbline of Craig Court, a distance of 533 metres or thereby.
B923 Kirkcaldy Road, Burntisland	From A909 Cowdenbeath Road to a point 156 metres or thereby northeast of the extended northeast kerbline of Greenmount Road North, a distance of 542 metres or thereby.
A921 Cromwell Road, Burntisland	For its entire length.
A921 Kinghorn Road, Burntisland	From High Street to the extended west boundary line of Burntisland Cemetery, a distance of 1145 metres or thereby.
Lochies Road, Burntisland	For its entire length.
Grange House Gardens, Burntisland	For its entire length.

..... Proper Officer of the Council

SCHEDULE 2
30mph Speed Limit

A921 Kinghorn Road, Burntisland	From the extended west boundary line of Burntisland Cemetery to a point 31 metres or thereby east of the extended east kerbline of Linwell Court, a distance of 277 metres or thereby.
A921 Aberdour Road, Burntisland	From Collinswell Drive to a point 28 metres or thereby west of the extended west kerbline of Bendameer Road, a distance of 506 metres or thereby.

..... Proper Officer of the Council

SCHEDULE 3
40mph Speed Limit

A909 Cowdenbeath Road, Burntisland	From a point 16 metres or thereby west of the extended northwest kerbline of Craig Court in a westerly direction for a distance of 643 metres or thereby.
---	--

..... Proper Officer of the Council

Picture caption: Map showing proposed speed limits – Burntisland (east)

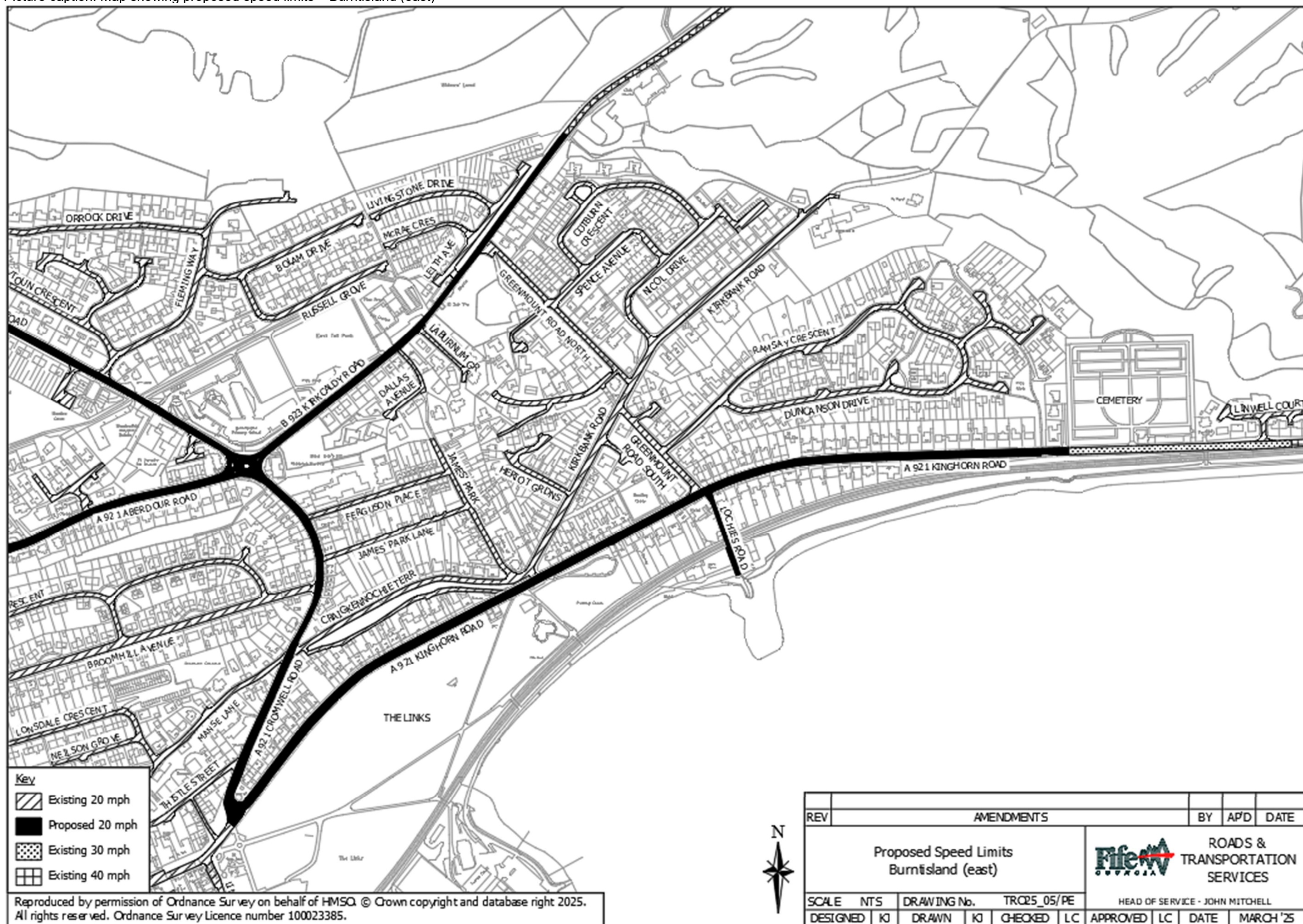

Picture caption: Map showing proposed speed limits – Burntisland (west)

