

THE FIFE COUNCIL (LOCHGELLY - 20MPH SPEED LIMIT) ORDER 2025

Fife Council propose to make an Order under the Road Traffic Regulation Act 1984 to introduce a 20 m.p.h. speed limit on the following roads in Lochgelly - B981 Auchterderran Road approx. 6m east of Grace Street to B920 Station Road approx. 457m; B920 Station Road approx. 189m north of Colquhally Road to B981 Auchterderran Road approx. 1074m; B981 Bank Street/Main Street/Lumphinnans Road/Viewfield Terrace from no. 36 Viewfield Terrace to B920 Station Road approx. 1450m; and the entire lengths of Weavers Row, Colquhally Road and Berry Street (cul-de-sac)

Full details of the proposals may be examined during opening hours at Fife Council Headquarters, Fife House, North Street, Glenrothes and via public access pc's at your closest library. The documents will also be available online at www.fife.gov.uk/notices

Objections to the proposals, stating the grounds of objection and the objector's name & address, should be sent to Traffic Management, Roads & Transportation Service, Bankhead Central, Bankhead Park, Glenrothes, Fife KY7 6GH or by e-mail to traffic.management@fife.gov.uk by 28/08/25.

31/07/25

THE FIFE COUNCIL (LOCHGELLY - 20MPH SPEED LIMIT) ORDER 2025

STATEMENT OF REASONS

The Fife Council, after consultation with the chief officer of police for the Council's area, proposes to introduce a 20mph speed limit at various streets in Lochgelly in the interests of road safety.

Lindsay Thomson,
Head of Legal and Democratic Services.

Fife House,
North Street,
GLENROTHES,
Fife.
KY7 5LT

THE FIFE COUNCIL (LOCHGELLY - 20MPH SPEED LIMIT) ORDER 2025

The Fife Council in exercise of the powers conferred on them under section 84(1) of the Road Traffic Regulation Act 1984 and of all other enabling powers, and after consultation with the chief officer of police for the Council's area in accordance with section 124 of and Part III of Schedule 9 to the said Act hereby make the following Order:-

1. This Order may be cited as "The Fife Council (Lochgelly - 20mph Speed Limit) Order 2025" and shall come into operation on the _____ day of _____.
2. No person shall drive any motor vehicle at a speed exceeding 20 miles per hour on the lengths of road specified in the Schedule to this Order.
3. Nothing in this Order shall apply to any vehicle which falls within regulation 3(4) of the Road Traffic Exemptions (Special Forces) (Variation and Amendment) Regulations 2011 when used in accordance with regulation 3(5) of those Regulations.
4. The Fife Council (Lochgelly High School and St. Patrick's RC Primary School, Lochgelly – Part Time 20mph Speed Limit) Order 2006 is hereby revoked.
5. Drawing number TRO25_23/PN and TRO25_23/PS showing the roads affected by this Order delineated in black is annexed and signed as relative hereto.

Dated this day of Two Thousand and Twenty Five.

..... Proper Officer of the Council

SCHEDULE

B981 Auchterderran Road, Lochgelly	From a point 6 metres or thereby east of the extended east kerbline of Grace Street to B920 Station Road, a distance of 457 metres or thereby.
B920 Station Road, Lochgelly	From a point 189 metres or thereby north of the extended northwest kerbline of Colquhally Road to B981 Auchterderran Road, a distance of 1074 metres or thereby.
B981 Bank Street / Main Street / Lumphinnans Road / Viewfield Terrace, Lochgelly	From the extended west boundary line of no. 36 Viewfield Terrace to B920 Station Road, a distance of 1450 metres or thereby.
Weavers Row Colquhally Road Berry Street (cul-de-sac)	For their entire lengths.

..... **Proper Officer of the Council**

Picture caption: Map showing proposed speed limits at the north end of Lochgelly.

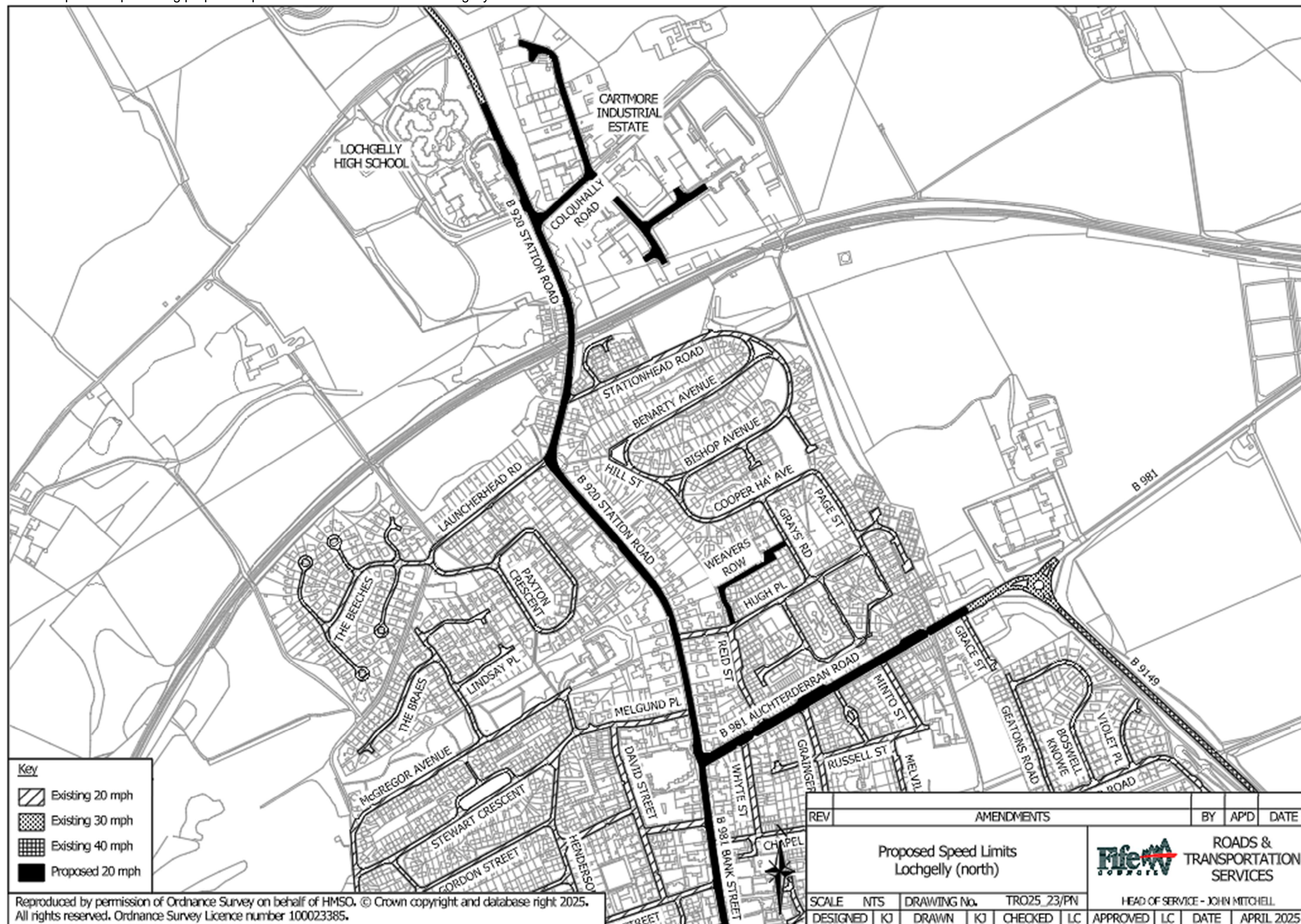

Picture caption: Map showing proposed speed limits at the south end of Lochgelly.

